



INSTRUCTION BULLETIN

No. 340514
Machine: ATLV 4300
Published: 04-2012
Rev. 02

NOTE: DO NOT DISCARD the Parts List from the Instruction Bulletin. Place the Parts List in the appropriate place in the machine manual for future reference. Retaining the Parts List will make it easier to reorder individual parts and will save the cost of ordering an entire kit.

NOTE: Numbers in parenthesis () are reference numbers for parts listed in Bill of Materials.

Installation instructions for **kit number 368657**

SYNOPSIS:

This kit contains the parts needed to install a backup alarm kit on the ATLV 4300 Litter Vacuum.
Please follow step-by-step instructions.

SPECIAL TOOLS / CONSIDERATIONS: NONE

(Estimated time to complete: 2 hours)



PROTECT THE ENVIRONMENT

Please dispose of packaging materials, old machine components, and hazardous fluids in an environmentally safe manner according to local waste disposal regulations.

Always remember to recycle.

PREPARATION:

1. Park the machine on a clean level surface.
2. Turn off the machine, remove the key, and set the parking brake.

FOR SAFETY: Before leaving or servicing machine, stop on level surface, set parking brake, turn off machine, and remove key.

3. Disconnect battery cables from batteries.



WARNING: Always disconnect battery cables from machine before working on electrical components.

INSTALLATION:

1. Mount the roller switch assembly (12) to the mounting holes under machine with two sleeve tubes (13), two pan screws (14), four washers (15), and two hex nuts (16). (Fig. 1 / Fig. 4)

NOTE: Mount the switch (12) carefully to ensure directional pedal/cable will touch the switch when the operator presses the heel of the directional pedal.

2. Connect the roller switch (12) to the main wire harness. (Fig. 1 / Fig. 2 / Fig. 3 / Fig. 4)
3. Align and hold the alarm mounting bracket (1) in mounting position on the left rear fender of the machine. Use the alarm mounting bracket (1) as a template to mark two mounting hole positions in left rear fender of machine. (Fig. 1)
4. Drill two 11/32" holes into the positions marked on the left rear fender of machine.
5. Mount the alarm mounting bracket (1) to the fender with three M8 hex screws (2) and three M8 flange nuts (3). If necessary, bend the alarm mounting bracket so it does not interfere with the hopper. (Fig. 1)
6. Mount the back up alarm (8) to the alarm mounting bracket with two M8 hex screws (2), two washers (10), and two M8 flange nuts (3). (Fig. 1)
7. Mount the spot light (11) to the alarm mounting bracket (1) with mounting hardware included with the spot light. (Fig. 1)
8. Plug the diode (7) into the diode key switch harness (6). (Fig. 1)

9. Use snap plug terminals (9) to connect the backup alarm (8) to the backup alarm wire harness (17) and spot light (11). (Fig. 2 / Fig. 3 / Fig. 4 / Fig. 5)

NOTE: Connect 31C GRN to the RED wire from the alarm and 37B GRN to the BLACK wire from the alarm. Connect 34B BRN to the BLACK wire from the light and 37A/37B GRN to the ORANGE wire from the diode. Connect the BLUE wire from the diode to the RED wire from the light. Completely tape connections when finished connecting wires. (Fig. 2 / Fig. 3 / Fig. 4 / Fig. 5)

10. Connect the backup alarm wire harness (17) to the main wire harness. (Fig. 2 / Fig. 3)
11. Remove the circuit breaker panel.
12. Use a pan head screw (6) and lock nut (7) to install the flasher bracket behind circuit breaker panel. (Fig. 1)

13. If machine is not already equipped with a circuit breaker / circuit breaker boot in location CB-5, install the circuit breaker (18) and the circuit breaker boot (19) into the that location in the circuit breaker panel. (Fig. 1 / Fig. 2)
14. Connect the main wire harness to the circuit breaker (18). (Fig. 2)
15. If machine is not already equipped with a flasher, plug the flasher (4) into the circuit breaker panel . (Fig. 2)
16. Connect the main wire harness to the flasher (4). (Fig. 5)
17. Reinstall the circuit breaker panel.
18. Reconnect the battery cables to the batteries.
19. Start the machine and test the back up alarm kit.

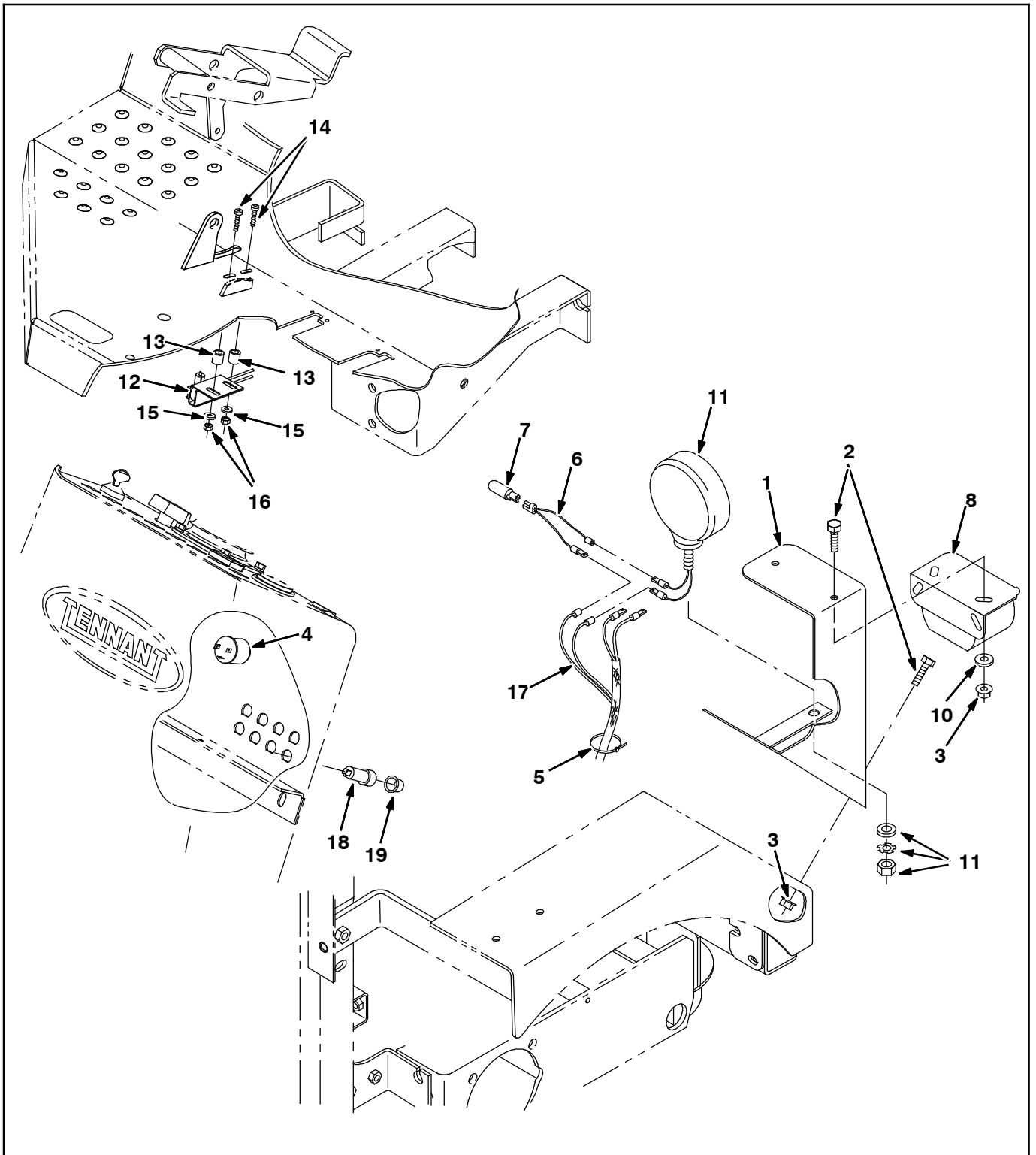

FIG. 1 - Backup Alarm Kit

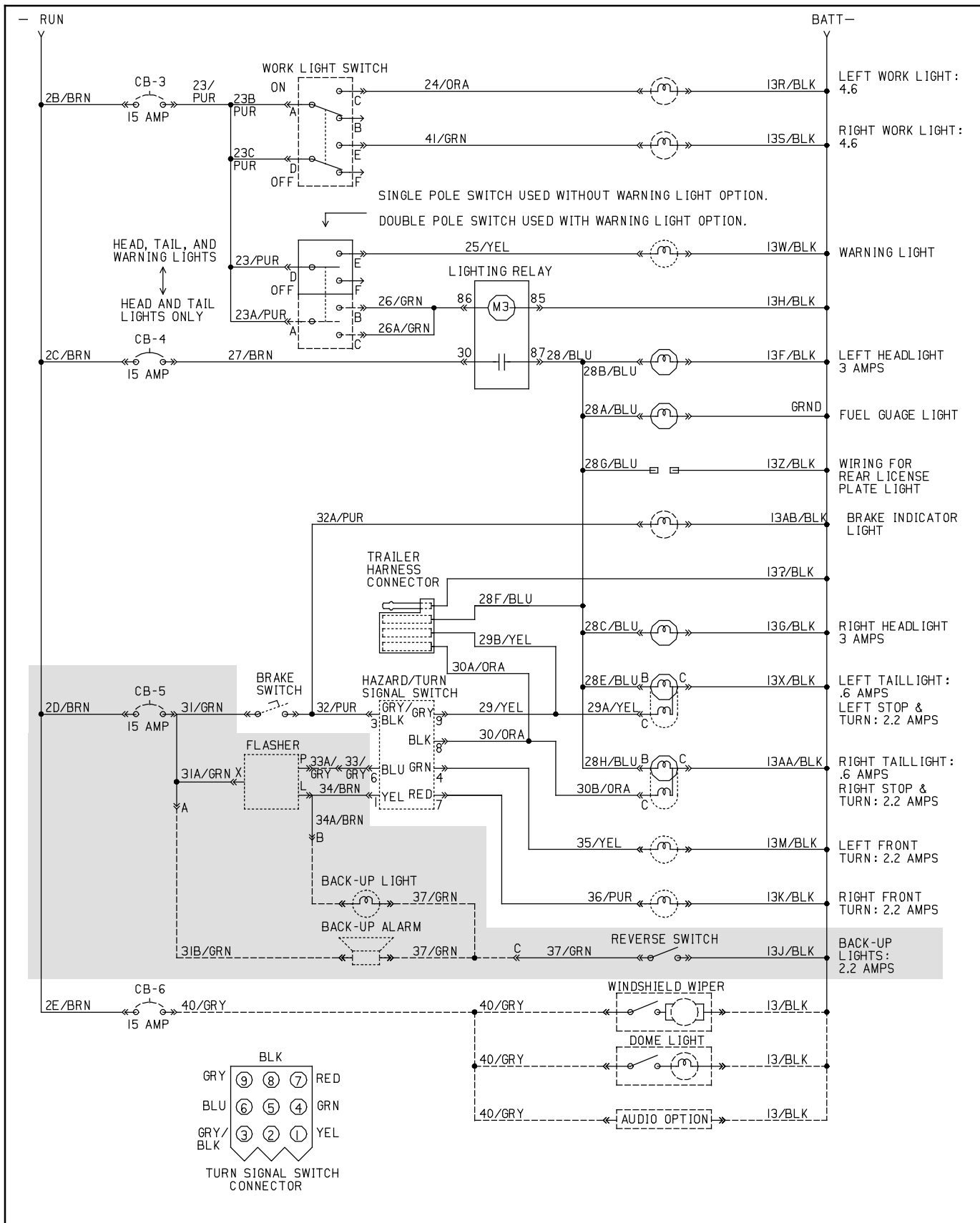

FIG. 2 - Backup Alarm Electrical Schematic

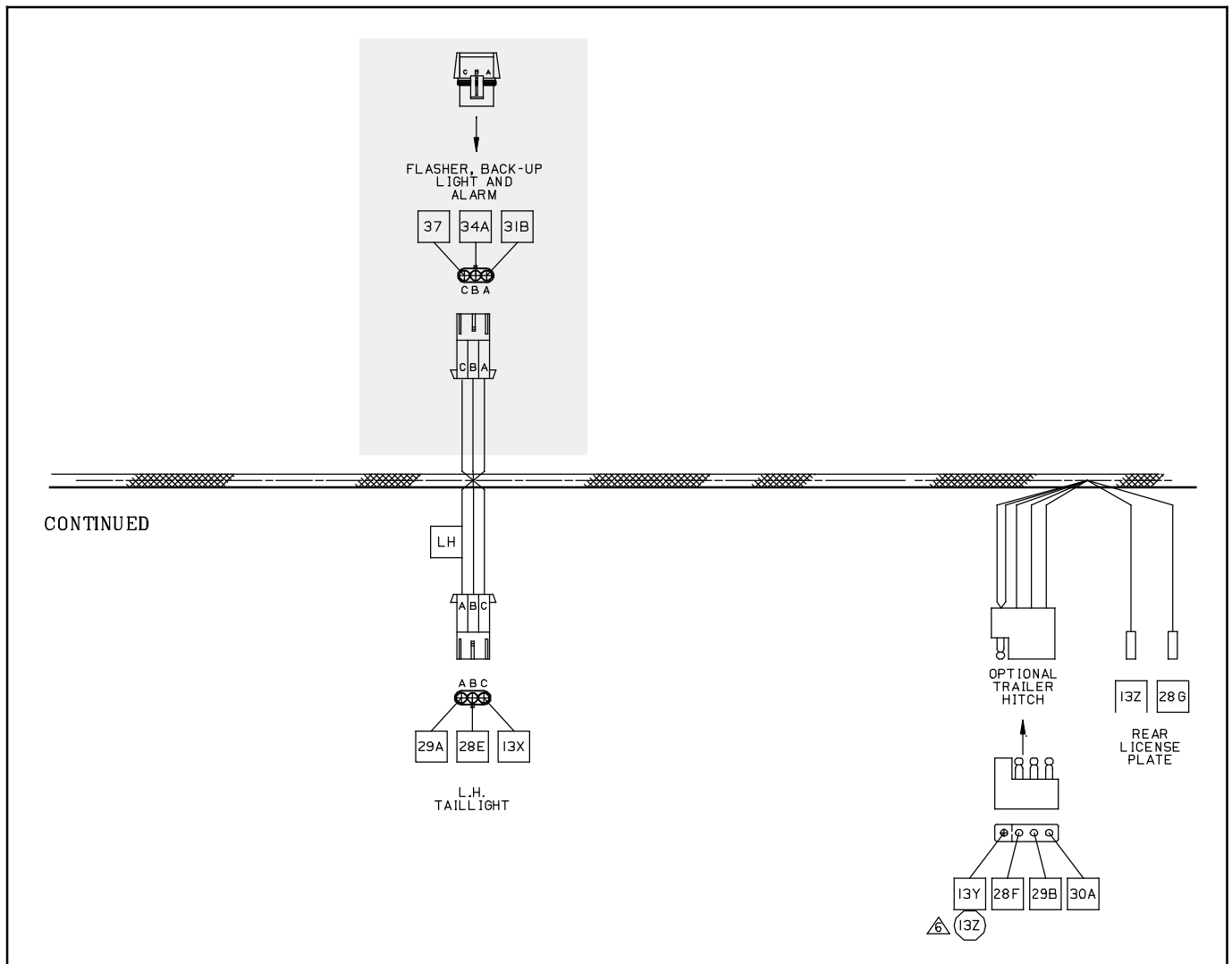

FIG. 3 - Backup Alarm Wire Harness Group

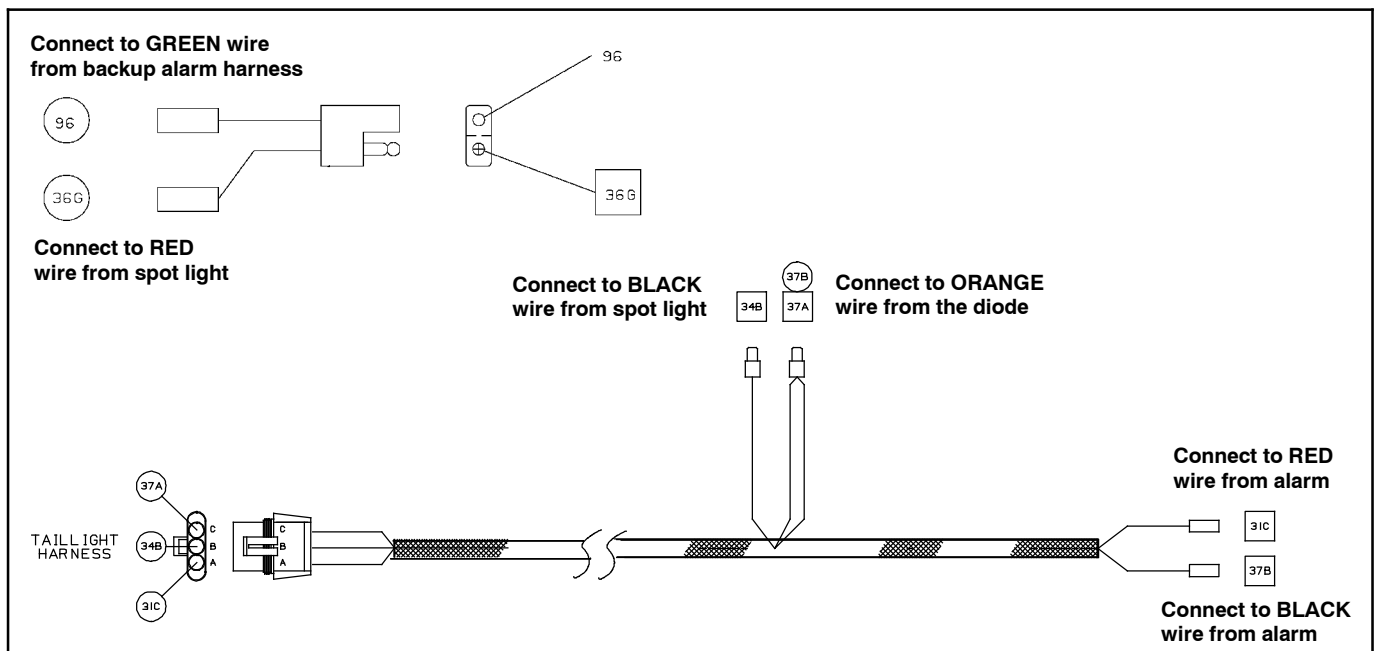

FIG. 4 - Backup Alarm Harness (17)

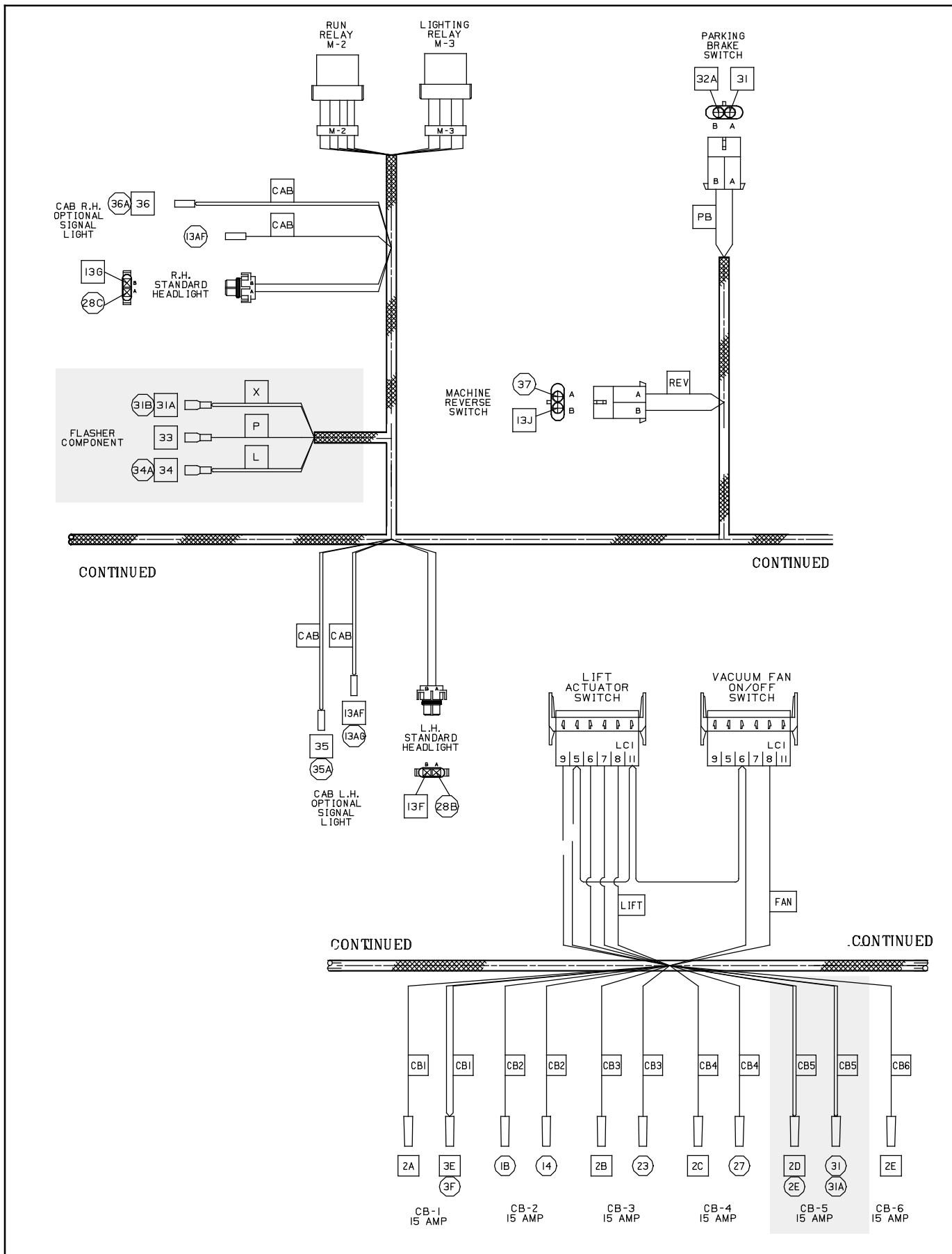

FIG. 5 - Main Wire Harness

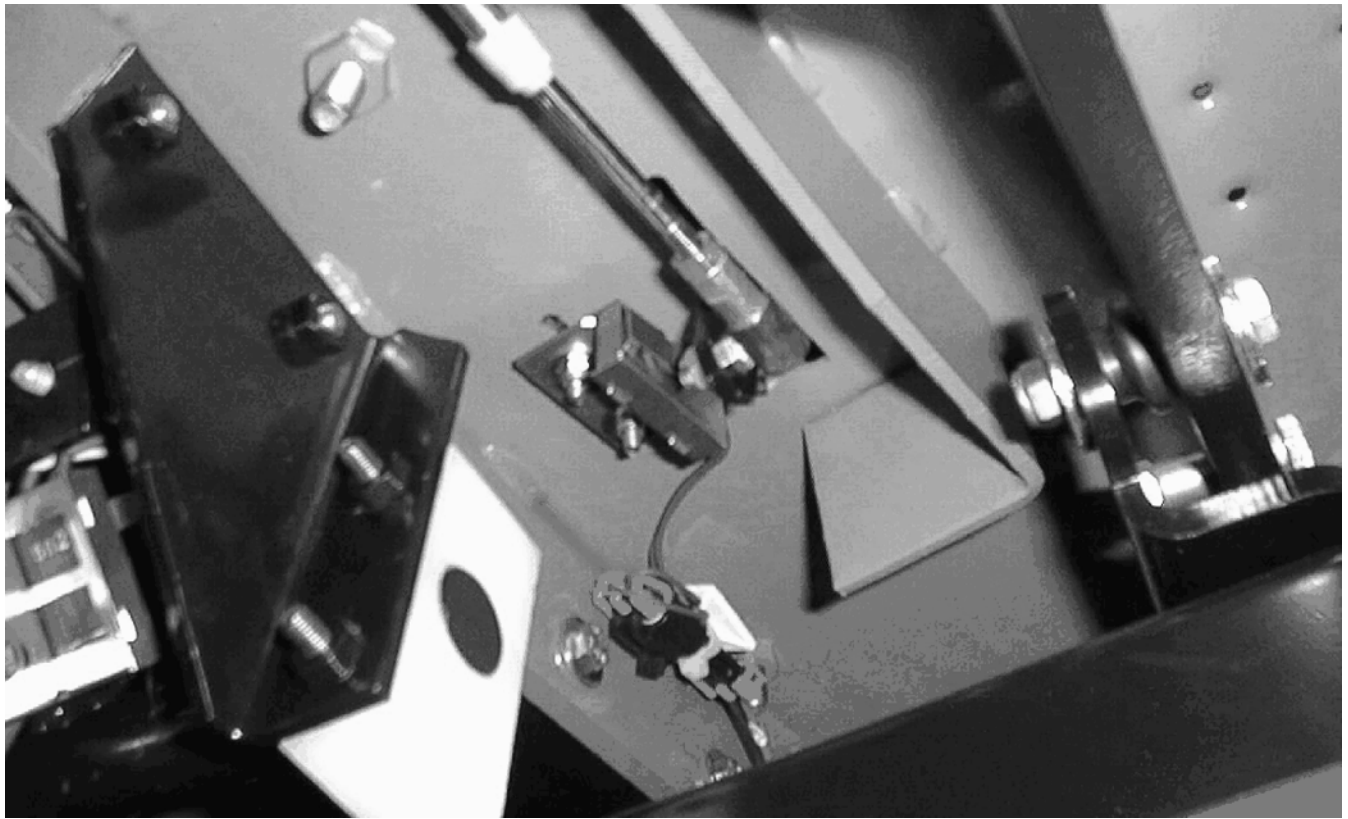

FIG. 6 - Backup Alarm Reverse Switch Installation

Bill of Materials for Alarm Kit, Backup / A/V, CI [ATLV]-368657

Ref.	Tennant Part No.	Description	Qty.
▽	368657	Alarm Kit, Backup / A/V, CI [ATLV]	1
▲ 1	368652	Bracket, Mtg, Alarm, Backup [ATLV]	1
▲ 2	16931	Screw, Hex, M8 X 1.25 X 20, 8.8	5
▲ 3	07791	Nut, Hex, Flng, M8 X 1.25	5
▲ 4	31922	Flasher, 12VDC 25A, Hd [10-57300]	1
▲ 5	49266	Tie, Cable, Nyl, 07.3L .19W 1.8 Max D	3
▲ 6	370156	Harness, Switch, Key, Diode	1
▲ 7	222290	Diode, Ele, Plug	1
▲ 8	1049968	Alarm, Backup, 12-24VDC 82-107DBA	1
▲ 9	55272	Terminal, Bullet, Mal, .157D, 12Ga	2
▲ 10	39349	Washer, Flat, 0.31 SAE	2
▲ 11	36438	Light, Spot, 12VDC, 21CP Rwk 44025A	1
▲ 12	367404	Switch Snap Actn, 12VDC 15A No Rlr	1
▲ 13	222460	Sleeve, P/M, 0.496D 0.318B 0.50L 430SS	2
▲ 14	24198	Screw, Pan, M5 X 0.8 X 25, SS	2
▲ 15	19066	Washer, Flat, #10	4
▲ 16	50335	Nut, Hex, Std, M5 X 0.8, 8	2
▲ 17	367402	Harness, Alarm, Backup [ATLV]	1
▲ 18	1064188	Circuit Breaker, 15.0A, Resettable	1
▲ 19	1064191	Boot, Circuit Breaker	1

TENNANT COMPANY
P. O. Box 1452
Minneapolis, MN 55440-1452